

SIZE:U16

ELECTRICAL CHARACTERISTICS:

| Part NO | Inductance Common Mode (mH) Min | Rated Current I _{rms} (Amp) | Resistance per Winding (ohm)Max | Inductance Differential Mode (μH)Min | Resonant Frequency (kHz)Min |
|------------|---------------------------------|--------------------------------------|---------------------------------|--------------------------------------|-----------------------------|
| XZM-U16100 | 22 | 0.75 | 1 | 230 | 170 |
| XZM-U16101 | 15 | 0.9 | 0.75 | 150 | 210 |
| XZM-U16102 | 10 | 1.1 | 0.44 | 100 | 280 |
| XZM-U16103 | 4.7 | 1.5 | 0.24 | 50 | 440 |
| XZM-U16104 | 2.2 | 2.3 | 0.095 | 20 | 650 |
| XZM-U16105 | 1 | 3.3 | 0.046 | 10 | 1000 |

OUTLINE DIMENSIONS

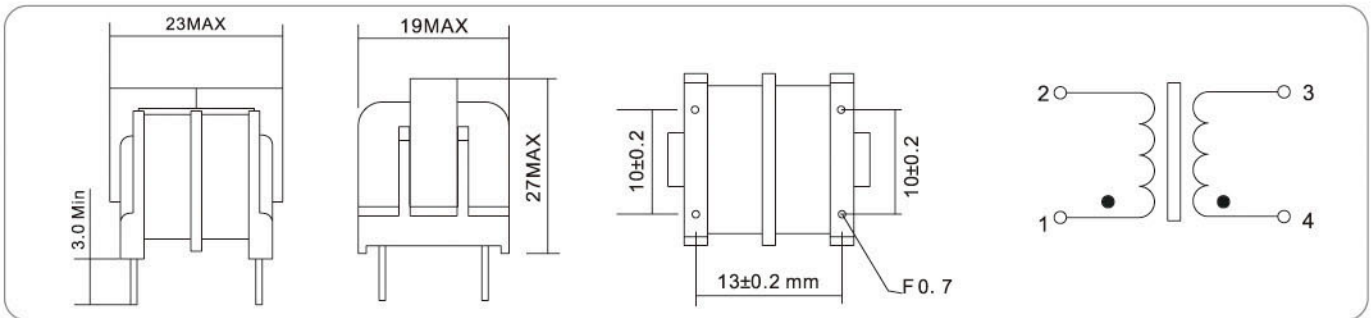

View from pin side PCB Drilling diameter 1.1mm

SCHEMATIC

SIZE:E25

ELECTRICAL CHARACTERISTICS:

| Part NO | Inductance Common Mode (mH) Min | Rated Current I _{rms} (Amp) | Resistance per Winding (ohm)Max | Inductance Differential Mode (μH)Min | Resonant Frequency (kHz)Min |
|------------|---------------------------------|--------------------------------------|---------------------------------|--------------------------------------|-----------------------------|
| XZM-E25102 | 22 | 0.9 | 0.54 | 130 | 170 |
| XZM-E25103 | 15 | 1.1 | 0.35 | 90 | 210 |
| XZM-E25104 | 10 | 1.3 | 0.22 | 50 | 270 |
| XZM-E25105 | 4.7 | 1.8 | 0.105 | 25 | 400 |
| XZM-E25106 | 2.2 | 2.7 | 0.05 | 11 | 630 |
| XZM-E25107 | 1 | 4 | 0.03 | 7 | 950 |

OUTLINE DIMENSIONS

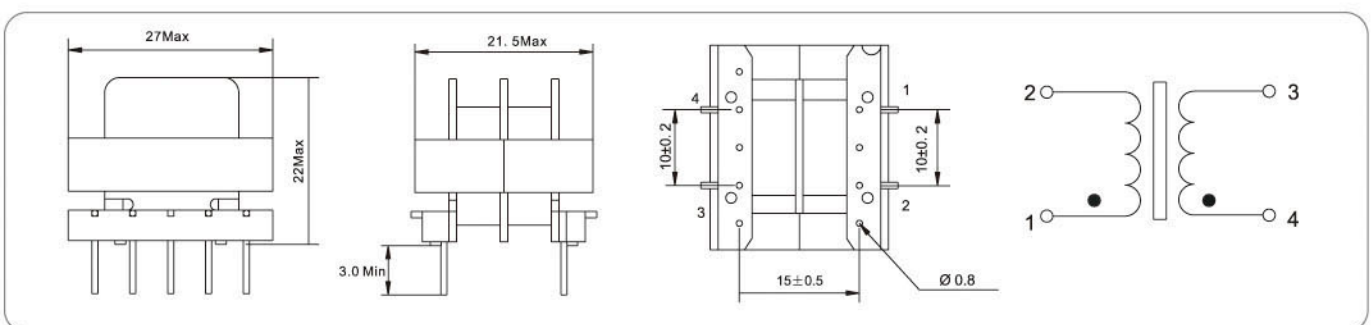

View from pin side PCB Drilling diameter 1.2mm

SCHEMATIC